

FLOTECS
Fluid/Flue solutions®

**FLOTECS -
ANTI-VACUUM
VALVE**

FEATURES & BENEFITS

The Flotecs - Anti-Vacuum Valve is set to open at a vacuum pressure of 50mbar. A dust cap prevents entry of foreign matter. WRAS approved.

- Size Range: DN20 - DN40
- PTFE to metal seating
- Brass

INSTALLATION

Flotecs - Anti-Vacuum Valve used to protect drying cylinders, storage cylinders, calorifiers and tankers from collapse due to internal vacuum. They are also used on the steam systems, to assist condensate drainage and to prevent suction of contents from vats. Vacuum Valves are normally fitted vertically, at the top of the vessel or pipeline being protected, horizontal revolving cylinders however should have a Anti-Vacuum Valve fitted at each end, diametrically opposite one another. The operation of valves in service should be checked every twelve months.

PRESSURE RATINGS & TEMPERATURE RANGE

MAX PRESSURE (bar)	MIN - MAX TEMPERATURE (°C)
11	-20 to 195

DIMENSIONS & WEIGHTS

SIZE DN	A (mm)	B (mm)	C BSPT (mm)	D-HEX	WEIGHT KG
20	61	36	3/4"	30	0.16
25	66	39	1"	36	0.26
32	76	43	1 1/4"	46	0.52
40	90	51	1 1/2"	52	0.77

PART NAME & MATERIALS

ITEM NO.	PART NAME	MATERIAL
1	Body	Bronze, BS EN 1982:1999 CB/CC491K
2	Seat Seal Holder	Brass, BE EN 12164:2011 CW602N
3	Spindle	Brass, BS EN 12164:2011 CW614N
4	Cap	Brass, BS EN 12164:2011 CW614N
5	Spring	Stainless Steel BS2056 302S26
6	Seat Seal	PTFE
7	Seat Seal Retaining Plate	Brass, BS EN 12164:2011 CW602
8	O-Ring	Viton E60C



MEDIUM

Hot water, steam, air.

PIPE CONNECTIONS (Female and male Connections)

BSPT (R) BS EN 10226-2. Male connections, R1/2, R3/4", R1", R1 1/4", R1 1/2" and R2" available.

PRODUCT TESTING

All valves are 100% production tested.

DRAWING

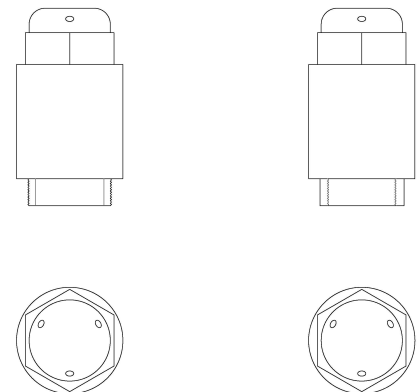

FLOTECS - ANTI-VACUUM VALVE

FLOTECS
Fluid/Flue solutions[®]

www.flotecs.co.uk / sales@flotecs.co.uk

