

FLOTECS
Fluid/Flue solutions[®]

FLOTECS
Air Vent

Series FAV

Automatic Air Vent Valve

Sizes: DN3 – DN25

Series FAV Automatic Air Vent Valves provide automatic air venting for hot or cold water distribution systems. These vents purge air that may be in the water system. The vent valve utilizes a float to actuate the valve plug which is located at the top of the valve. Once the air is displaced and the system pressure is sustained, the valve plug seals and prevents any water from escaping from the system. The float vent can also operate as an anti-vacuum device since it will permit air to enter the system when it must be drained. It can also be installed to permit the separation and dispersal of air while fluid is actually circulating in the system.

Features

- Body and cover are brass construction
- Air vent with silicone rubber seal
- Impurities do not usually affect function as maximum float line of water is always lower than the valve seal
- Float is high temperature resistant polyethylene
- Suitable for use with glycol systems
- Can be disassembled for inspection and cleaning

Pressure-Temperature

- Minimum working pressure: 10 kPa
- Maximum working pressure: 10 bar
- Temperature Range: 5°C – 116°C

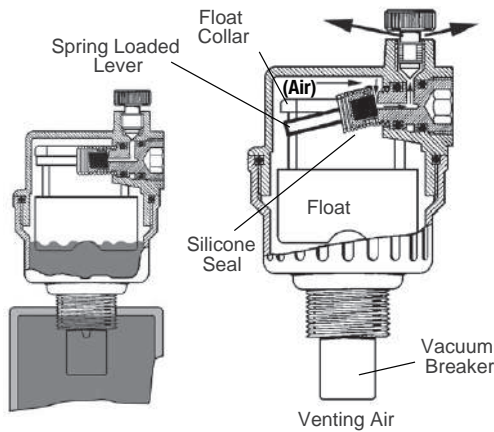

Installation Dimensions

SIZE (DN)	DIMENSIONS						WEIGHT
	A	B	C	D*	E	F	
1/8	75	67	41	21	7.9	7.9	.18
1/4	79	67	41	21	3.1	12.7	.20
1/2	85	69	32	18	16	–	.20
3/4	85	69	32	18	16	–	.20
1	89	69	35	18	20	–	.21

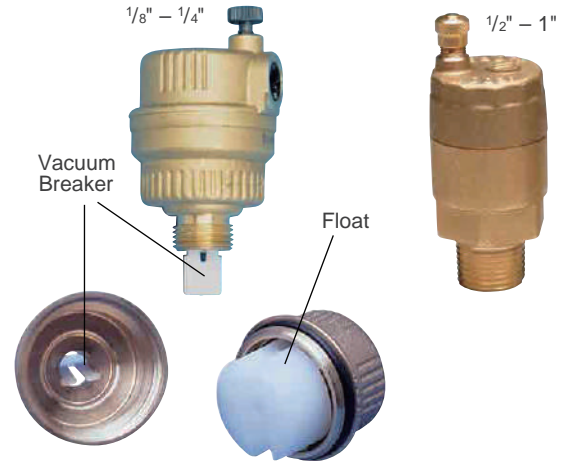

Characteristic Curve

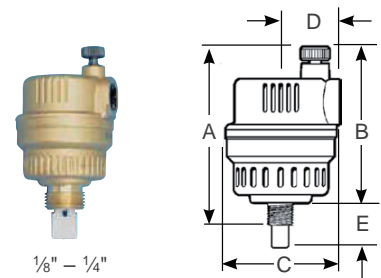
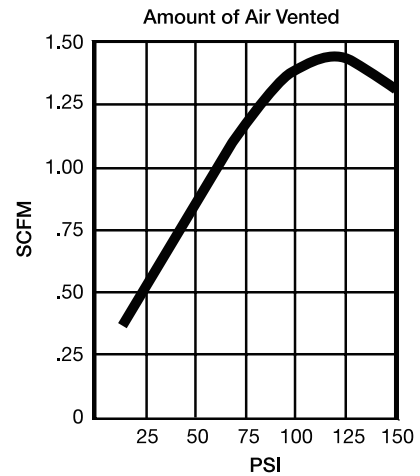

1/8" - 1/4"



1/2" - 1"

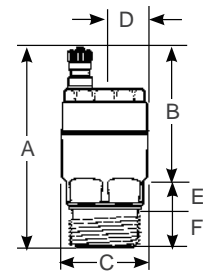

Installation

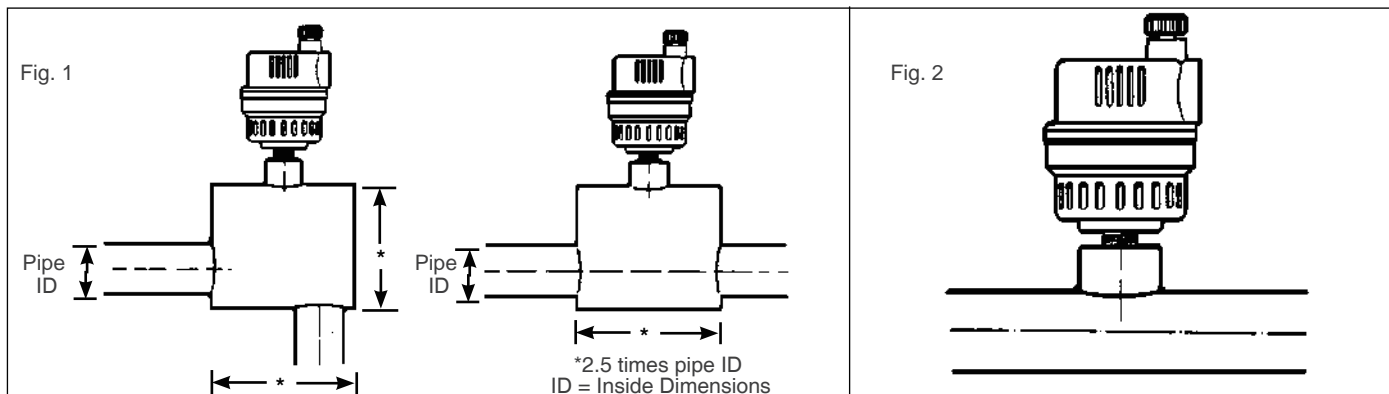

Figure 1 shows the installation of the FAV for the venting of air while the fluid is circulating in the system. The figure shows the required increase in pipe size in order to obtain proper separation of air from water. Watts Series AS Air Scoop which is designed for efficient separation of air from water in hydronic heating systems can also be installed. See Watts literature S-AS.

Figure 2 When the FAV is installed as shown, the air will not be vented while the fluid is circulating in the system, but it can vent when the system is shut off. The FAV should be mounted only in a vertical position as its operation is based on the vertical movement of the float (see Fig. 3). **Note:** In order to get the best results in venting air from risers, use connecting pipes of at least 1/2" diameter between the "Float Vent" valves and the installation.

Fig. 3

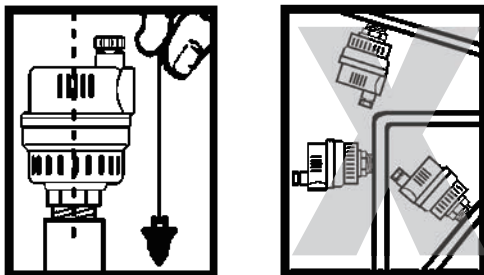
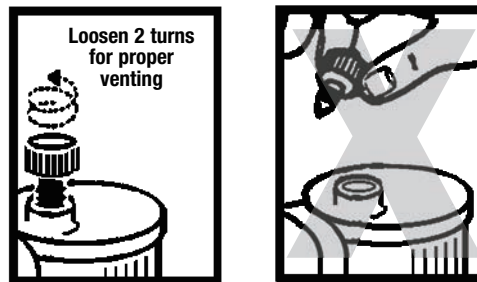

Fig. 4



Maintenance

Corrosive water conditions, and/or unauthorized adjustments or repair could render the product ineffective for the service intended. Regular checking and cleaning of the product's internal components helps assure maximum life and proper function. When the FAV is disassembled for inspection or cleaning, it is important that when re-assembling to ensure that the spring loaded lever properly engages under the float collar (see reverse side).

Operation: IMPORTANT!

After installing the FAV, back off the small vent cap two turns (see Fig. 4). This is the proper operating setting which will allow air to be vented from the system. It is advisable to leave the cap on to prevent impurities from entering the valve.

Series FAV2

Automatic Air Vent Valves Float Vent

Size: DN10-DN25

Series FAV2 Float Vent valves are automatic and/or manual devices for venting air from heating and air conditioning systems.

Features

- Vertical automatic air vent valve
- Pre-sealed with O-ring
- Suitable for installation on the head connections of coplanar manifolds
- Brass body

Pressure-Temperature

- Nominal Pressure: PN10
- Temperature Range: 5°C–110°C

Test Pressure

Pneumatic
6bar

Material

NO.	Component	Material
1	Body	Brass
2	Control Mechanism	Stainless steel
3	Retaining Spring	Stainless steel
4	O-ring seal	EPDM
5	Disc	Silicone rubber
6	Float	Stabilized polypropylene
7	O-ring Pre-sealing	EPDM
8	Vacuum breaker	Polyacetal
9	Retaining Disc	PA with fiberglass

Installation Dimension

DN	A	B	C	D	weight(g)
3/8"	30	10	77	36	135
1/2"	30	10	77	36	150
3/4"	32	12	79	36	160
1"	37	12	79	36	170

Characteristic Curve

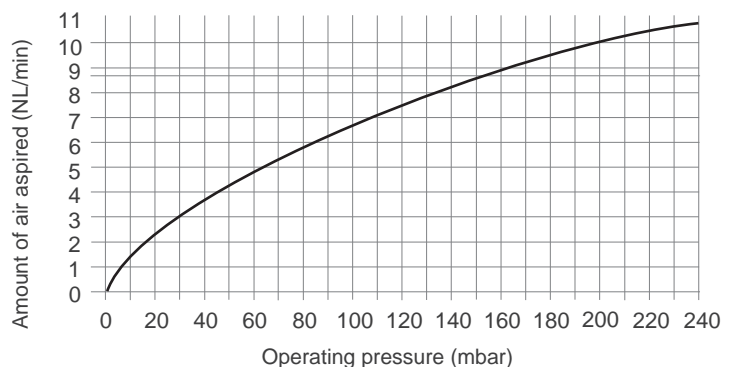
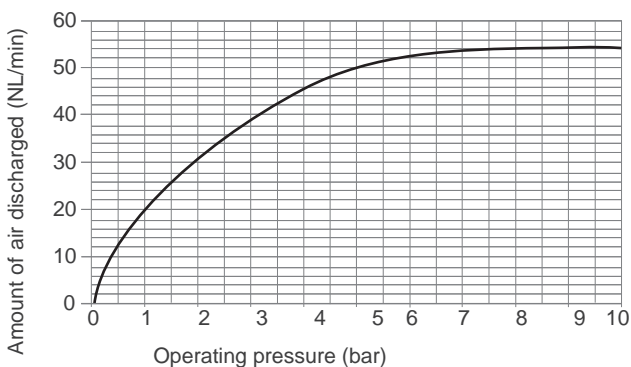

Specification

- Connection Standard: DIN-ISO 228/1

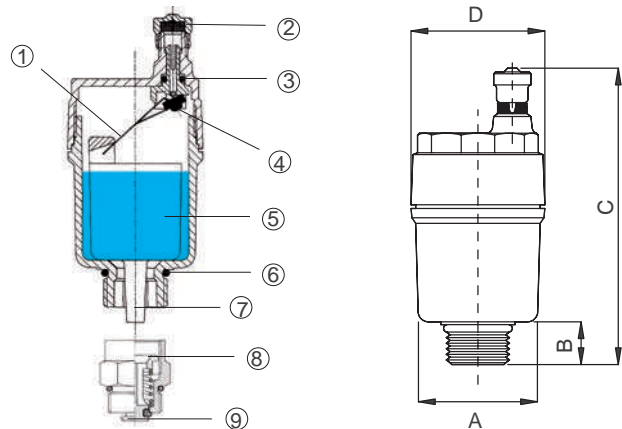

Series FAVF

Float-type Air Vent Valves MAXIVENT

Size: DN20-DN32

Series FAVF Float Vent valves are high flow automatic devices for venting air from heating and air conditioning systems.

Features

- Cast iron body and cover coated with epoxy
- Manufactured to deal with high flow rates
- Used to venting air from large water distribution pipes
- Can be equipped with manual air vent valve

Pressure-Temperature

- Nominal Pressure: PN12
- Temperature Range: 5°C~115°C

Material

Component	Material
Body	Cast Iron coated with epoxy resin
Cover	Cast Iron coated with epoxy resin
Manual Vent Valve	Chrome-plated brass
Lever	Stainless Steel
Disc	NBR
Float	High-density expanded polythene
Seals	NBR
Cap	Brass

Installation Dimensions

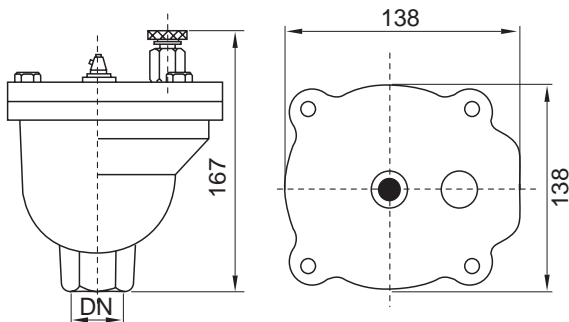

Note: Nominal diameter DN range from 20mm to 32mm



Specification

- Connection Standard: DIN-ISO 228/1
- Test Standard: EN 1074

Characteristic Curve

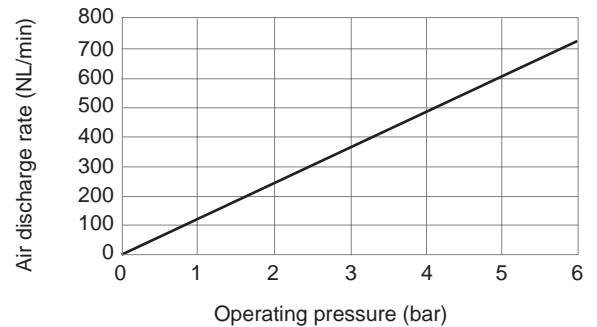

FLOTECS

Air Vent

FLOTECS
Fluid/Flue solutions[®]

www.flotecs.co.uk / sales@flotecs.co.uk

